



Friends of  
**Port Willunga**  
PO Box 1138,  
Aldinga Beach 5173  
[www.friendsofportwillunga.com](http://www.friendsofportwillunga.com)

## **Friends of Port Willunga 2017-2018 Summer update**

As we head towards the 2018 AGM to be held at **11am** in the **Aldinga Institute Hall** on **Sunday January 21st 2018**, here is a quick update from the Chair on what your committee has been up to over the past year.

### **1. Martin's Barn remedial work and linear reserve planting**

This year the Friends of Port Willunga (FOPW) welcomed collaboration with the City of Onkaparinga's Natural Area Conservation team to develop a comprehensive planting plan for the foreshore and linear reserve area.



To date this has involved planting of over 1,500 seedlings in the dune system, and liaison with Council's Martins Barn Project Team regarding vegetation surrounding the barn. Some early planting of river red gums along the creek line has been undertaken, and we look forward to coordinating a large community planting event in June 2018. The consultation process also revealed that the former Caravan Park site is still zoned "Dedicated for Caravan and Camping purposes". FOPW will formally propose that Council request that the parcel be re-dedicated by the Crown "for Coastal Purposes", so that planting and re-establishment of the dune system can be undertaken on that site.

### **2. ALDI Supermarket and retail development**

The first stage of the ALDI development – the supermarket building – was completed and opened at the end of 2017. FOPW lobbied for below-rooftop signage and evergreen landscaping, which is all now in place. While the height of the floor level and amount of signage was not reduced, the view of Aldinga Uniting church from Main South Road has been preserved as a focal point. The overall design is much more sympathetic to the historic town than the standard Aldi design, the result of years of lobbying from FOPW and other community groups. Traffic congestion in old Aldinga, and the impact of suburban-style road works on the heritage precinct is however an ongoing issue. We will not know how this resolves itself until the South Road roundabout and Old Coach Road upgrades are completed. The second stage of the development – a set of terraced retail outlets along the north side of Port Road designed to soften the overall development – will create further traffic and heritage impacts, however the developer has not yet advised council when (or whether) they intend to proceed with that stage of the development.

### **3. South Road and Port Road intersection and Aleppo pine avenue**

The upgrade of Main South Road between Old Coach Road and Malpas Road is under way. FOPW are keen to see new landscaping and tree plantings on both sides of the Main South Road roundabout to replace the significant number of trees lost in the upgrades and developments of the past several years, and will liaise with DPTI and Council to that end. FOPW continue to advocate for the replanting of the Aleppo pine avenue along Port Road, and will lobby Council to budget for that in the 2018/19 financial year. The long term concept of a bypass around the east side of St Anne's Church, to reconnect the church to the rest of Aldinga Village, and to separate highway through-traffic from township destination traffic is also supported by FOPW.

### **5. Aldinga Township upgrade**

The Aldinga Township concept plan was prepared by the City of Onkaparinga following community engagement in 2012. The design of the shared zone for cars and pedestrians south of the Old Coach Road roundabout (between the Homegrain Bakery and Miss Gladys sites) is however causing confusion. Council have informed us that this section is all still a work in progress, with works currently suspended in order to

relieve the impacts on summer trade. At the AGM we will seek your views on the possible removal of street car parks from this section, and the provision of car parking elsewhere, to improve the visibility and safety of pedestrians and overall ambience of the precinct. We will also seek feedback on whether there is support for eventually creating a pedestrian-only zone here, if alternative car parking and access were provided. Council has informed us that once the project is completed an audit will assess if any amendments are required.

## 6. Dam proposal for Bowering Hill

In response to community consultation during 2017, the proponents of the Bowering Hill dam have further revised their design proposal. The main changes compared with earlier designs include:

- Moving to a smaller single dam and locating it in the north-east corner of the block further from Old Coach Road and Iverene Road
- A more organic design incorporating current land use aspects
- Increasing the slope of the wall on the north, west and southern sides from a 1 in 3 to a 1 in 10 slope
- Reducing the maximum dam wall heights, giving a maximum height of 6.2m on the south-western corner
- Increasing the density of vegetation around the perimeter; and
- A reduction in water storage capacity of 20% from the original design.

According to the proponents the key benefits that are achieved from these changes include:

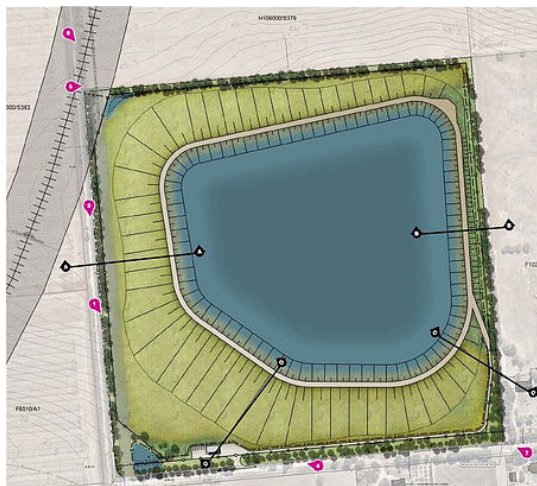

- Enabling approximately 35% of the site to continue to be used for traditional broad acre farming using the 1 in 10 slopes of the dam walls
- Reducing the height of the dam wall on the south-east corner and locating it further away from the neighbouring property
- Opening the view to the west by reshaping the dam and moving the dam further north
- Reducing impacts on the neighbours to the south of Iverene Road by reducing the height of the wall and shifting it away from Iverene Road.
- Reducing the dam wall height adjacent Old Coach road and shifting it further away from the road.

The application has however been placed on hold by the applicant, due to ongoing negotiations with the state government regarding the land acquisition.

## 7. Fund My Neighbourhood proposals

The FOPW committee thanks our members for their support for the Port Willunga Heritage Walk as part of the 2017 Fund My Neighbourhood round of voting. Unfortunately the project didn't get enough votes for this round, however members will be pleased to hear that one of the successful projects was a safe cycling track between Willunga and Aldinga. FOPW will continue to explore ways to fund the heritage walk, and seeks our membership's views on allocating some of our own funds to that end.

## 8. Mount Lofty Ranges World Heritage Bid

The Barossa, Adelaide Hills, Mount Barker, Mitcham, Onkaparinga, Alexandrina, Yankalilla, Light, and Clare and Gilbert Valley councils are collaborating with Regional Development Australia and the University of Adelaide to complete Stage One of their bid for UNESCO recognition of the Mount Lofty Ranges - National Heritage nomination. The consortium submitted the national nomination to the federal government in early 2017, however a decision to proceed to assessment is yet to be made, mostly due to a lack of State Government commitment to the project. Work on Stage Two - World Heritage nomination - is therefore being undertaken in tandem with state government consultation and the national assessment processes.

I thank all our committee members for their hard work in 2017, and look forward to seeing many of you at the AGM on January 21st, where we will hear from Fleurieu farmer and foodie Rachel McMillan, and provide you with an opportunity to voice any of your own concerns or ideas.

Stephanie Johnston

**Chair, Friends of Port Willunga Committee**